

July | August 2015

AN EXCLUSIVE NEWSLETTER FOR THE RESIDENTS OF LAKE WISCONSIN

## Staying Safe on Your Boat While Enjoying the Lake

Reprinted from Wisconsin DNR

Operator inexperience, inattention, recklessness, and speeding are the four leading causes of tragic watercraft crashes and the leading cause of death is drowning. Crash statistics indicate boaters who wear life jackets and take boater safety courses are most likely to stay safe on Wisconsin waters. Follow these basic safety tips and enjoy Wisconsin's great lakes and rivers with family and friends.

### LEAVE ALCOHOL ONSHORE

Never use drugs or alcohol before or during boat operation. Alcohol's effects are greatly exaggerated by exposure to sun, glare, wind, noise, motion of the water, and vibration. Almost half of all boating accidents involve alcohol. That should be reason enough to leave alcohol consumption for when you are safely on shore with no plans to travel...

Operating a boat while intoxicated is a federal offense, subject to a \$1,000 fine. Add to that – criminal penalties, which are as high as \$5,000, things can get expensive quickly and may even include jail time.

State "Boating Under the Influence" (or BUI) Laws are becoming more stringent, too. In most states, the standards for determining whether an individual is intoxicated matches its state highway laws for operating a vehicle. In Wisconsin, those who operate a boat in the state are not allowed to have a blood alcohol content level (or BAC) of .08 or above. Penalties for BUI in Wisconsin can include fines, impounded boats, and jail time. There were 241 boaters cited for BUI/OWI in 2013. Anyone found to be operating a boat or other watercraft is deemed to have given consent to an alcohol or drug test by authorities.

---

*Keep the fun on the water coming -- whether it's a fishing boat, a canoe, or a personal watercraft that "floats your boat."*

---

### USE AND MAINTAIN THE RIGHT SAFETY EQUIPMENT

- Have a U.S. Coast Guard-approved life jacket for each person onboard and one approved throwable device for any boat 16 feet and longer. The DNR recommends that everyone wear their life jackets while on the water; especially children. Life jackets with collars and attached whistles are the best for children.
- Have a fire extinguisher on board at all times.
- Have operable boat lights - Always test boat lights before the boat leaves the dock and carry extra batteries.
- Emergency supplies - Keep on board in a floating pouch containing cell phone, maps, flares and first aid kit.

### CONSIDER A FREE VESSEL SAFETY CHECK

Take advantage of a free vessel safety check from the US Coast Guard. They offer complimentary boat examinations to verify the presence and condition of certain safety equipment required by state and federal regulations. Free of charge, they'll provide a specialist to check out your boat and make helpful boating safety tips and recommendations. They also offer virtual online safety checks as well. For more information visit

*Continued on page 3...*





# Boating Safety *continued from front page...*

<http://wow.uscgaux.info/content.php?unit=V-DEPT&category=i-want-a-vsc>

## BE WEATHER WISE

Regardless of the season, keep a close eye on the weather and bring a radio. Sudden wind shifts, lightning flashes and choppy water all can mean a storm is brewing. If bad weather is approaching, get off the water early to avoid a long waiting line at the boat launch during inclement weather. Even heavy wind storms can cause smaller boats to capsize.

## TAKE THESE STEPS BEFORE GETTING UNDERWAY

- Tell someone where you are going and when you will return.
- Open all hatches and run the blower after you refuel and before getting underway. Sniff for fumes before starting the engine and if you smell fumes, do not start the engine.
- Check the boat landing for any local regulations that apply.

## LOADING AND UNLOADING YOUR BOAT

Overloading a boat with gear or passengers will make the boat unstable and increase the risk of capsizing or swamping. Abide by the boat's capacity plate which is located near the boat operator's position.

## FOLLOW NAVIGATION AND OTHER RULES ON THE WATER

- Never allow passengers to ride on gunwales or seat backs or outside of protective railings, including the front of a pontoon boat. A sudden turn, stop or start could cause a fall overboard.
- After leaving the boat launch, maintain a slow-no-wake speed for a safe and legal distance from the launch.

## TAKE SPECIAL COLD WATER PRECAUTIONS IN SPRING AND EARLY SUMMER

Cold water temperatures reduce your margin for error on the water: if you fall

in or your boat capsizes, you may have as little as two minutes before losing your ability to move your muscles and get back in the boat or seek help. Even when the weather is warm, do not forget that in many areas the water can be very, very cold. A sudden unexpected wake or other "unbalancing event" can land you in the frigid water...

## BOATING COURSE REQUIREMENTS

Wisconsin boating safety certification or out of state equivalent certification is required for operators born on or after January 1, 1989. Anyone is eligible to take the class and receive a safety education completion certificate, however, courses are designed at a 5th grade level or up. For complete details, please read the Handbook of Wisconsin Boating Laws and Responsibilities on-line at <http://dnr.wi.gov/files/PDF/pubs/LE/LE0301.pdf>



## WHO MAY OPERATE A BOAT?

- No one under the age of 10.
- Children 10 years of age but less than 16 if accompanied in the boat by a parent or guardian or a person at least 18 years of age designated by a parent or guardian.
- Anyone at least 12 years of age may operate a motorboat if they have successfully completed a DNR prescribed boating safety course and possess a

boating safety certificate issued by the Wisconsin DNR or another state.

- There are no age requirements for operating a boat that is not equipped with a motor.

## WHO MAY OPERATE A PERSONAL WATERCRAFT (PWC)?

- No one under the age of 12 may operate, lease or rent a personal watercraft.
- No one under the age of 16 may rent or lease a personal watercraft.
- Children at least 12 years of age may operate a personal watercraft if they have successfully completed a DNR prescribed boating safety course and possess a boating safety certificate issued by the Wisconsin DNR or another state. Adult supervision is not a substitute for a certificate.

## COURSE REQUIREMENTS

All Wisconsin recreational safety students are required to obtain a Wisconsin DNR Customer ID Number before the completion of any recreational safety class and will be required to provide that customer ID number along with students' personal information to the instructor. You can obtain a DNR Customer ID Number:

- Online via link on the website of the course
- By calling DNR customer service from 7:00 a.m. to 10:00 p.m. at 1-888-936-7463
- By visiting a DNR service center during regular scheduled hours.

## INTERNET COURSES

Boat operators now have convenient online methods to receive an Official Boater Safety Certification through Internet courses. For all states and Canada, you can now access and register for certification courses by going to <https://www.boat-ed.com>.

*Enjoy the Lake!*



# Lake Wisconsin Real Estate Market *Improving*



**TerraFirma**  
TFM WISCONSIN, INC.

888.470.5253

Email [info@TFMwisconsin.com](mailto:info@TFMwisconsin.com)



**A**fter five years of inconsistent growth year-over-year unit sales and sold prices finally saw substantial upward movement in the period of January 1st to June 15th, 2015.

With 29 Lake Wisconsin Homes sold at an average of \$332,496, unit sales saw a 40% jump from the same period in 2014 while the price of homes climbed 9% above the 2014 average sold price of \$306,633.

This also compares well to the preceding 5-year average of 21.5 unit sales and represents a 21% increase in sold prices where the 5-year average was \$275,079.

This positive news can be attributed to several factors such as "still" historically low interest rates, stock market increases, job growth, increase in Buyer's home equity, and improving consumer confidence in the economy.

Many economists and every lender we have spoken with forecast an increase in interest rates beginning the third quarter of 2015. While we have not heard of a quick or substantial rate increase, most are predicting a slow, steady increase which may have an impact on the real

estate market continuing its strong upward trend.

With the improving Lake Wisconsin Real Estate market, strong economic climate, and fear of rate increases, NOW may be the time to sell your home if you are looking to move.

The team at Terra Firma Realty would be happy to meet with you and provide a free market analysis of your home to see if the current value aligns with your sale objectives.

Our broad and aggressive marketing efforts, 25,000+ Buyer database, and our team-based approach - focused on South Central Wisconsin Lake Property - allow us to provide you the best opportunity to be successful in the sale of your home.

Please feel free to contact us by phone at 608-846-5253, email at [Info@TFMwisconsin.com](mailto:Info@TFMwisconsin.com) or visit our website at [LakeWisconsinProperty.com](http://LakeWisconsinProperty.com). Also, be sure to LIKE us on Facebook!

## LOCAL July 4th Fireworks Celebrations

### July 3rd

- Portage – Fireworks at dusk at Pauquette Park, Hwy 33 over the Wisconsin River; Wisconsin Chamber Orchestra will perform at 7:30pm. Visit [www.portagewi.com](http://www.portagewi.com) for more information.

- Merrimac – Fireworks at dusk by Merrimac Fire Dept; just off S7116 Bluff Road just north of Merrimac.

### July 4th

- Baraboo – Fireworks at dusk at the Baraboo H.S., 1201 Draper Street. Free event!

- DeForest – Spectacular Fireworks Display at dusk, Fireman's Park, 500 Jefferson Street, downtown DeForest. Two-day festival starts on July 3rd with entertainment, beer tent, live music, freedom run and food. Visit [www.vi.deforest.wi.us](http://www.vi.deforest.wi.us) for more information.

- Lake Mills – Fireworks at dusk, Industrial Park on Business Park Dr; concessions open at 7pm.

- Pardeeville – Parade at 12 noon with Fireworks at dusk, Chandler Park, east of Hwy 44, left on Park Drive

- Prairie du Sac – "Fire on the River" at Sauk City Riverwalk, 726 Water Street in Sauk City [www.fireontheriver.org](http://www.fireontheriver.org)

- Reedsburg – Freedom Fest 3pm until dusk... Fireworks at dusk at Nishan Park (on Hwy H), Reedsburg. Visit [www.reedsburgwi.gov](http://www.reedsburgwi.gov) for more information.

- Wisconsin Dells – Fireworks Extravaganza at dusk at Wisconsin Dells Municipal Pool, 510 Veterans Drive

### July 18th

- Dekorra – Dekorra Fest – Events start at 1pm; Classic Car, Tractor & Snowmobile Show; music, food, drinks & kids activities...

Fireworks Celebration at dusk in the field at the corner of McMillan & Hall Road, near Poynette-Dekorrra recycling center. Bring your lawn chairs and blankets. Visit [www.dekorrrafireworks.com](http://www.dekorrrafireworks.com) for more information.

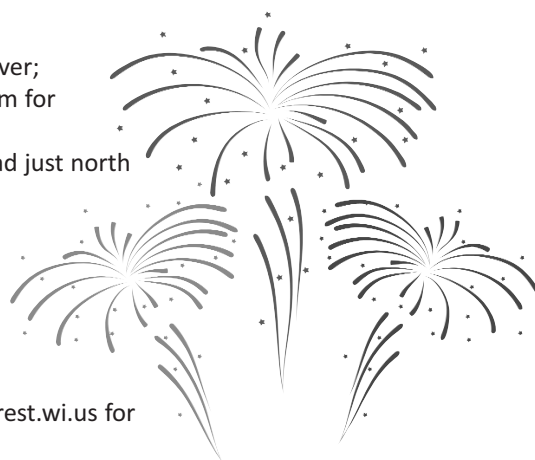

## Lake Wisconsin Country Club

welcomes you to an *elegant* and *intimate* setting, overlooking beautiful Lake Wisconsin with sunsets over the lake that give the clubhouse dining room and bar an ambience *like no other*.

Receptions • On-Site Ceremonies  
Rehearsal Dinners • Cocktail  
Parties • Hors D'Oeuvre Buffets  
Accommodating up to 240 Guests



### FRIDAY NIGHT FISH FRY

Fried or Broiled Haddock  
Choice of Potato • Includes Soup &  
Salad Bar \$13.95  
Every Friday from 5pm - 9pm



*Lake Wisconsin*  
COUNTRY CLUB

www.lakewisconsincc.com • (608) 643-4554  
N1076 Golf Road • Prairie Du Sac, WI

## FAWN CREEK WINERY



**OPEN DAILY, 11AM to 5PM**  
(excluding major winter/spring holidays)

**Extended Summer Hours:**  
Open until 7PM Fridays & Saturdays  
Memorial Day through Labor Day  
with live music, Saturdays & Sundays

With this ad, get 1 logo glass with  
the purchase of 1 bottle of wine.  
(Limit 2, while supplies last)

LWL

**3619 13<sup>th</sup> Ave., Wis. Dells**  
**(608) 253-4400**

**fawncreekwinery.com**  
**info@fawncreekwinery.com**



## COMPUTER COTTAGE

### Convenient in-home computer repair

Virus/Spyware removal  
Wireless networking  
Network security  
Printer problems

Lost passwords  
No start/boot and BSDs  
System cleanup/tuneup  
and much more...

www.Computer-Cottage.com

608-616-9943



**"HANGIN' LOOSE AT  
THE THIRSTY MOOSE!"**

**LIVE MUSIC  
TIKI BAR  
BOAT DOCKS  
AND PIER**

**Food & Spirits**

**SERVING SANDWICHES** TUES - SUN • 11AM-9PM

N3135 Cty Rd V • "On Lake Wisconsin" • 608-635-4311  
Only 3 miles west off I90/94 at C5 exit

# MANKE Enterprises

## Boat Lifts

## Docks

## Sales & Service

*Where life meets the lake!*

**ShoreStation** **voyager**™  
DOCK

**PORTA-DOCK**

QUALITY SINCE 1954  
**WICKCRAFT**  
company, inc.

924 Development Drive, Suite C • Lodi, WI  
www.manke.com

**608-592-4022**



**Wisconsin has more  
than 500,000  
registered  
motorboats—about  
one for every 10  
residents.**

**Thank you to the  
homeowners who refer  
advertisers in your  
newsletter.**

**They make this newsletter  
free of charge for the  
waterfront residents of  
Lake Wisconsin.**

**When possible, please  
utilize their services!**

**newsletter@TFMwisconsin.com**

## **Lake Wisconsin Alliance (LWA) Hosts Fish Shocking Demo**

**N**early 60 people attended a fish shocking demonstration at Whalen's Grade on May 9th. This free event was presented by Nate Nye and Dan Fuller with the Wisconsin Department of Natural Resources and hosted by the Lake Wisconsin Alliance.

Nate and Dan first provided a little background information about the equipment they would use to complete the fish shocking demonstration. Fish biologists place an electrode into the water in order to "stun" fish near the boat so they can collect data such as species, size, and age. The fish are unharmed and are released after the data are collected. Surveys like this are conducted on lakes, rivers, and streams throughout Wisconsin in order to determine the types of species and fish populations of the waterbody being surveyed.



Nate and Dan completed the demonstration by taking the boat from Whalen's Grade boat launch along the grade and onto Whalen's Bay under the bridge over Hwy V. Once their route was complete, they dropped anchor at the bridge and started displaying fish to the eager crowd above. They collected a number of species including popular game fish such as walleye, small/largemouth bass, and Northern pike as well as pan fish such as blue gills, perch, and sunfish. Nate also provided some information about each fish species including habitat, place in the food chain, and commonality to Lake Wisconsin. The youngsters in the crowd were very knowledgeable on their fish species and could have challenged any local fisherman on their identification skills!

This was the third of six educational opportunities planned for 2015. The next session is scheduled for July 9, 2015, 6:00pm at Lucky's on the Lake in Okee (W11579 Co Rd V, Lodi, WI 53555) and is titled "Blue-green Algal Blooms in Wisconsin: Identification, Ecology, Causes, and Potential Health Effects".

### **Additional Upcoming Meetings & Events**

- Thursday, July 23, 2015, Board Meeting, 6:30pm, Lucky's Bar & Grille on Lake Wisconsin (check LWA Facebook to verify location)
- Thursday, August 29, 2015, Annual Member Meeting, 12-2pm, Lucky's Bar & Grille on Lake Wisconsin (check LWA Facebook to verify location)

If you have questions about membership, feel free to contact Ross Ament at 608-635-2779 or [rament1@hotmail.com](mailto:rament1@hotmail.com) or to be added to the email communication list contact Kirk Boehm at 608-209-2850 or [kmb.boehm@gmail.com](mailto:kmb.boehm@gmail.com). Also be sure to LIKE the Facebook page for LWA at [www.facebook.com/LakeWisconsinAlliance](http://www.facebook.com/LakeWisconsinAlliance). By doing this you will be able to regularly see information related to future meetings and educational programming.

*Lake Wisconsin Alliance (LWA) – a recently developed, non-profit (501(c) 3, citizen advocacy organization with a mission to endeavor to balance the diverse interests of the Lake Wisconsin community while improving recreational opportunities, water quality, and sustaining a healthy ecosystem within the Lake Wisconsin watershed.*



# BUSINESS... Spotlight

## Marketing RECREATIONAL REAL ESTATE



# Terra Firma

TFM WISCONSIN, INC.

**T**erra Firma Realty (TFM) is a real estate brokerage company specializing in residential real estate on or near water.

Terra Firma utilizes a unique business model in that they have a dedicated sales team to service their selling clients, a marketing team with a successful history of marketing recreational real estate, and a successful sales plan that steers away from commercial, income producing and multi-family properties so they can maintain their focus on what they do best - connecting people with water. In addition, Terra Firma also

owns a database of over 25,000 buyers which in many cases helps them quickly locate a buyer for their selling clients.

Terra Firma has a team of seven people including five licensed real estate agents. The staff at Terra Firma have a real passion for water and either live on the water themselves or enjoy water activities throughout the year. Terra Firma is involved in the community, a member of the Lodi/Lake Wisconsin Chamber of Commerce, publishes Lake Wisconsin *Living*, and is involved with the Lake Wisconsin Alliance (LWA) working to improve the water quality of Lake

Wisconsin.

Since 2010 Terra Firma has been #1 in sales on Lake Petenwell (upstream from Lake Wisconsin and also part of the Wisconsin River) five years in a row and has outsold the next five brokerages combined during that time.

With their office in DeForest, WI it just made sense that they would bring the same successful business model and marketing strategies to Lake Wisconsin, especially since some of their employees live on the lake and spend so much time on and around Lake Wisconsin.

You can visit Terra Firma's website at [www.TFMwisconsin.com](http://www.TFMwisconsin.com) or visit their Lake Wisconsin specific site at [www.LakeWisconsinProperty.com](http://www.LakeWisconsinProperty.com). They would love to help you buy or sell Lake Wisconsin area real estate.

## Looking to buy or sell waterfront property?

**Terra Firma  
is your  
Waterfront  
Property  
Specialist!**

Proven history of  
Real Estate success

Lake property marketing &  
sales experts

Huge database of vacation  
home buyers

Local area and home  
market expertise

Looking to list?  
Use us for the best results!

Preferred financing to fit  
buyers needs and situation



# Terra Firma

TFM WISCONSIN, INC.

**(888) 470-5253**

5008 Linde Lane, Suite 400 • DeForest, WI 53532  
Michael J. Coke • Kirk M. Boehm

[www.TFMwisconsin.com](http://www.TFMwisconsin.com) | [www.LakeWisconsinProperty.com](http://www.LakeWisconsinProperty.com)



NEWSLETTER@TFMWISCONSIN.COM

LakeWisconsinProperty.com

- 1 FITZ'S
- 2 LAKESIDE
- 3 MOON VALLEY
- 4 REMI'S THIRSTY MOOSE
- 5 LAKE WISCONSIN WALLEYES LLC.
- 6 LAKE WISCONSIN COUNTRY CLUB
- 7 LUCKY'S BAR AND GRILLE

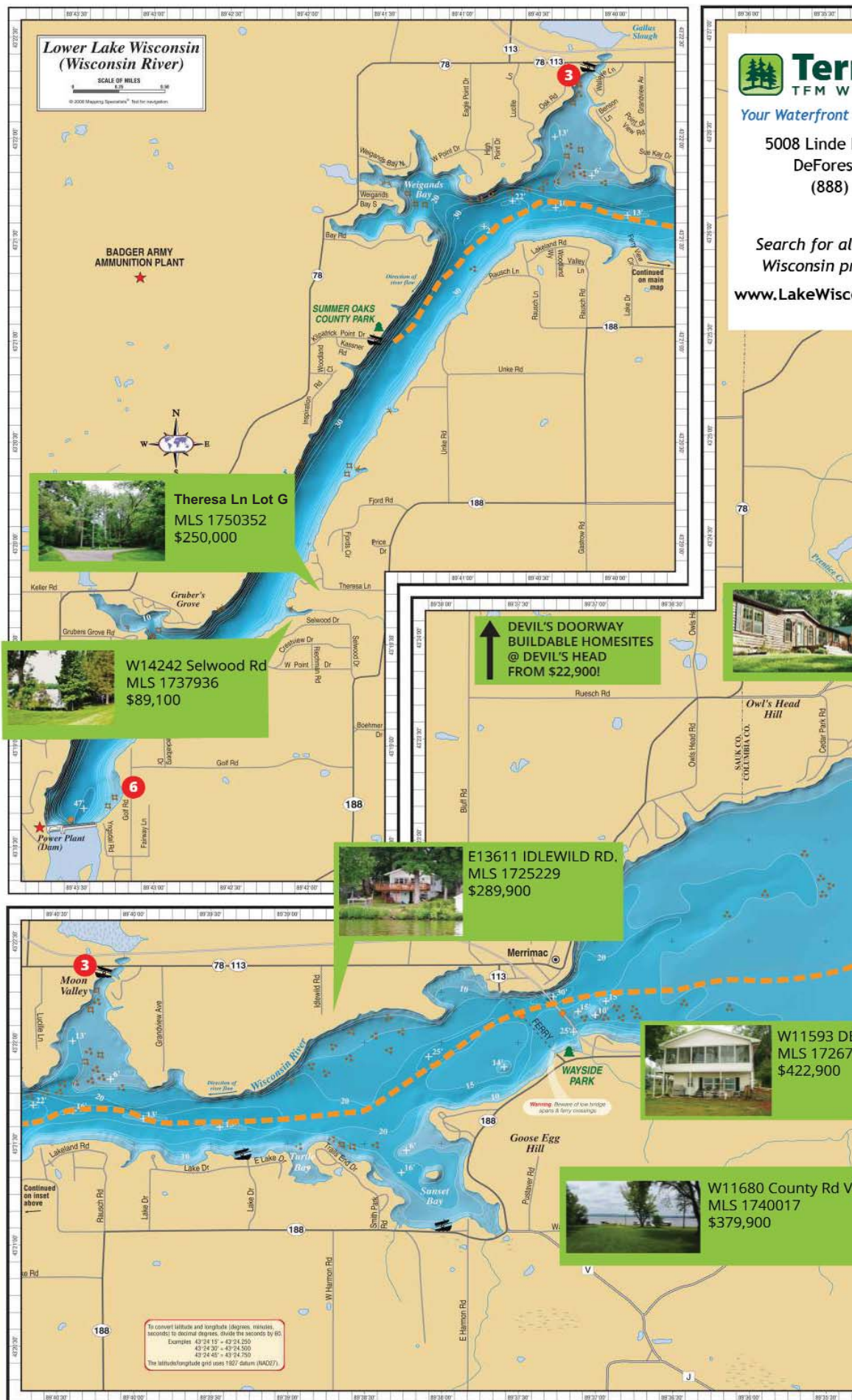



**raFirma**  
WISCONSIN, INC.  
Property Specialists!

Lane, Suite 400  
t, WI 53532  
470-5253

l available Lake  
Property listings.  
onsinProperty.com

**Lake Wisconsin**  
(774 feet above sea level)  
9,000 acres Max. depth 47 feet

BOAT LANDING (trailer access)	FISH CRIB	SAND/GRAVEL
BOAT LANDING (hand-carry)	NAVIGATION HAZARD	STUMPS
PARK	ROCK	VEGETATION

SCALE OF MILES  
0 0.25 0.5 1

**Mapping Specialists**  
1319 Appleton Rd. Phone 608.274.4004  
Madison, WI 53713 Fax 608.274.9689  
www.mapping-specialists.com

© 2008 Mapping Specialists, Ltd. All rights reserved. No part of this work may be reproduced or copied in any form or by any means without the express prior written consent of Mapping Specialists, Ltd. The information contained in this product was derived from the best knowledge of the publisher at the time of publication. The publisher assumes no legal responsibility for the inclusion or exclusion of places on this map. Any updates can be submitted to Mapping Specialists, Ltd. for inclusion in future editions. Made in the U.S.A. Final Edition. Not for navigation.

**LOT:**  
**EAGLE BLUFF CT.**  
**MLS 1730931**  
**\$115,000**

**N3376 KOEPP RD.**  
**MLS 1694237**  
**\$234,900**

**EMNYCK RD.**  
**44**

**N2421 RAPP RD**  
**MLS 1706998**  
**\$450,000**

**W9598 Parkway Dr.**  
**MLS 1728525**  
**\$789,000**

**Upper Lake Wisconsin**  
(Wisconsin River)  
SCALE OF MILES  
0 0.25 0.5 1

© 2008 Mapping Specialists, Ltd. Not for navigation.

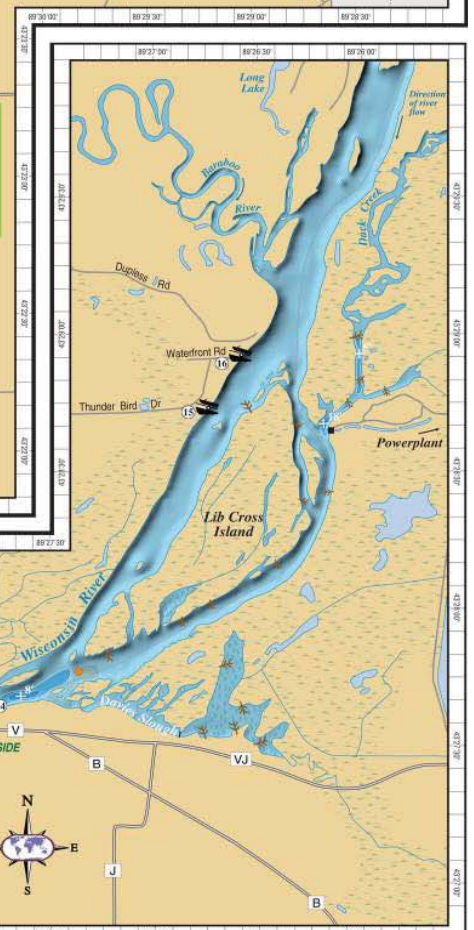

**Using the GPS Coordinates**  
Coordinates are in degrees, minutes, and seconds. The maps are located on the lake every 30 seconds. Each line in the map margin represents 5 seconds. The coordinates are intended to help you find the approximate location of features in the lake.

43 24'00" 89 28'30"  
43 23'50" 89 28'20"

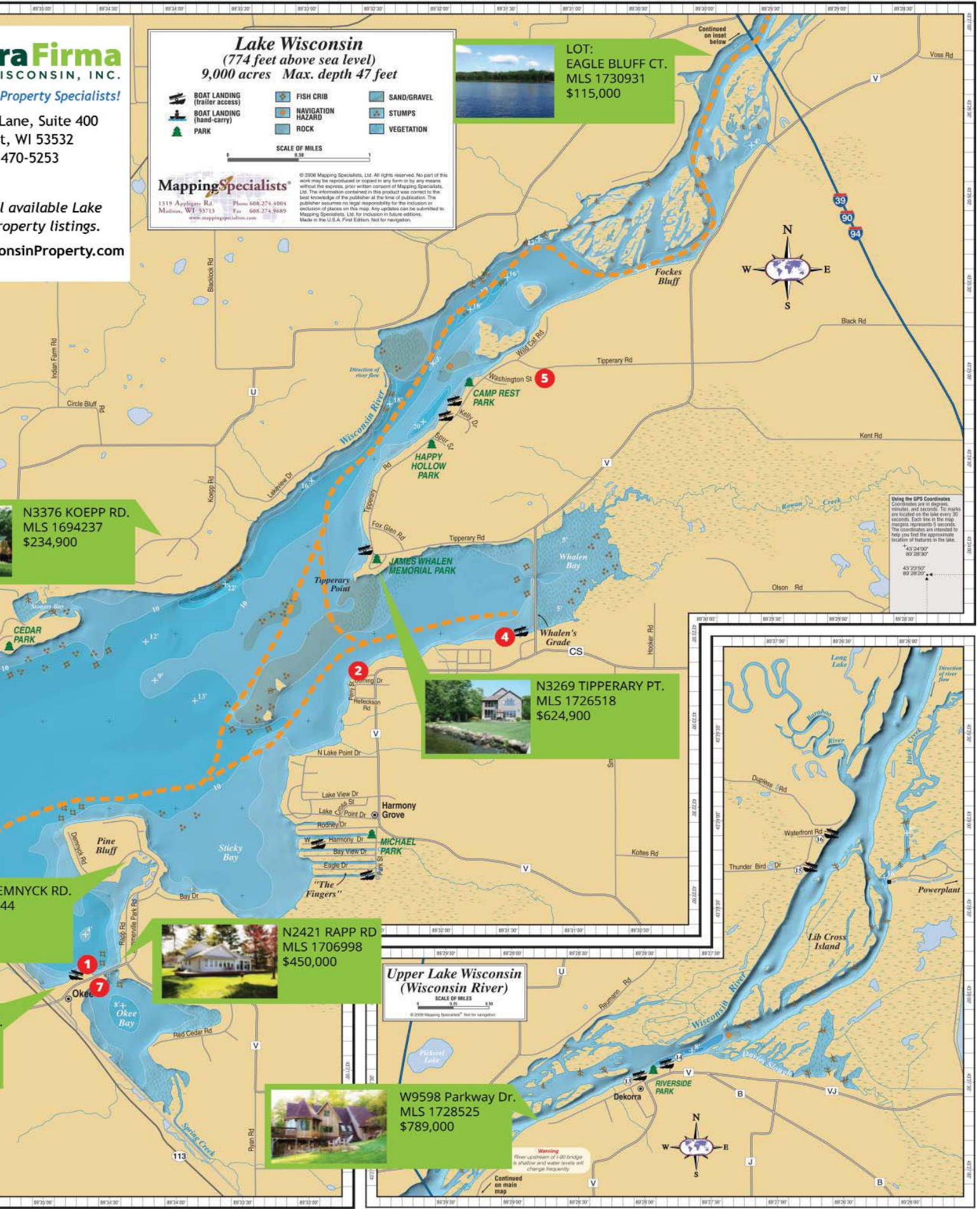



# Fishing on Lake Wisconsin and the Wisconsin River

By Gary Sanders • Lake Wisconsin Walleyes, LLC • [www.lakewisconsinwalleyes.com](http://www.lakewisconsinwalleyes.com)



**W**hile fishing on Lake Wisconsin and the Wisconsin River in mid to late summer, there are three main things we typically find; High surface temps of 80°+, a significant algae bloom, and slower flow coming downstream. A fourth is a less frequent, but all too common occurrence in summer, the dreaded mayfly hatches.

Fishing always seems to be on a downhill slope after the 4th of July through to October. It's not because there are a lot less fish, but because conditions change. The forage base is at its seasonal peak, which means more food in the lake to compete with. Additionally as summer progresses, we start to see more fish suspending over deeper water in the western portion of the lake. We usually do so well in June, that it can take a number of outings before we accept that we need to gradually do things a bit different later in the summer to keep hooking up.

Often times the same old techniques that we have been using still work... We just may need to adjust locations a bit. For example, we spend much of June fishing the mud flats in 8'-10' above the trestle. Those fish are still around, especially during a mayfly hatch, but increased surface temps tend to push fish a bit deeper at times. Usually all that's required is to fish a similar, but deeper lake feature. Try adjusting your presentation to fishing a nearby 15' timbered flat and bingo, there they are. If not keep moving progressively deeper or down the lake until you get on them. Trust your electronics, and look for those banana shaped hooks wherever you may find them in the water column. Possibly suspended 10' down over 23' depths, or suspended off the channel edge, maybe laying right on the bottom in the main channel. Methodically try different presentation until something works, or simply move to a similar location elsewhere, to see if fish holding there are more active.

Mayfly hatches are inevitable, and they do make fishing more difficult, as most fish tend to key on the emerging mayflies as they rise up from the bottom. I have had success during hatches using a variety of techniques at different times; jigging, bottom bouncers, trolling crank or stick baits etc... but the best tactic I've found to deal with a mayfly hatch, is to NOT deal with it. Simply try to get above the hatch. What I mean is, to relocate by running up the lake or the river in order to get upstream from where the biggest hatch is occurring. Sometimes hatches are so big it's hard to find anywhere they are not, but typically you can. If you just can't get away from the hatches, I've had the most success pulling bottom bouncers with a crawler harness or slow death rigs.

*Tight Lines, Gary Sanders*

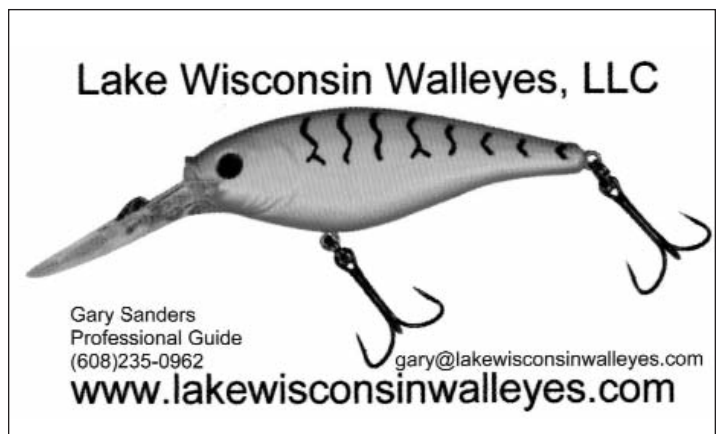

## **“CALL TODAY” to advertise your business in Lake Wisconsin Living!**

Lake Wisconsin *Living* newsletter is mailed directly to the property owners on Lake Wisconsin (approximately 2,000) and electronically delivered to another 13,000 individuals who have expressed interest in owning property on Lake Wisconsin. With a per issue circulation in excess of 15,000 and 90,000+ annual readers, your audience will be extensive.

**To place an ad in this newsletter, please contact  
[newsletter@TFMwisconsin.com](mailto:newsletter@TFMwisconsin.com). For additional information,  
please visit our Website at [www.LakeWisconsinLiving.com](http://www.LakeWisconsinLiving.com).**





*Interior & Exterior  
Commercial & Residential Painting*

**608-643-6049**

828 Industry Road • Sauk City, WI 53583

## PIANO LESSONS

Daytime Voice and Piano Lessons  
Perfect for Adults of all ages and home schooled students!

Time slots available

**9AM TO 2 PM • MONDAY - FRIDAY**

**592-1780**

**JEANNE PLOTTS VOICE AND PIANO STUDIO, LLC**  
109 First St., in Lodi (Next to Post Office)



**Terra Firma**  
TFM WISCONSIN, INC.

*Looking to buy or sell waterfront property?*  
**Terra Firma is your waterfront property specialist!**

**5008 Linde Lane, Suite 400 • DeForest, WI 53532**

**Phone: 608.846.5253**

**Michael J. Coke • Kirk M. Boehm**

[www.TFMwisconsin.com](http://www.TFMwisconsin.com) | [www.LakeWisconsinProperty.com](http://www.LakeWisconsinProperty.com)

**CUSTOM**

CONSTRUCTION & DESIGN, INC.  
W10632 Tipperary Road, Poynette, WI 53955

(608) 635-5303

**Joe Wajnert**

• [customcdi@aim.com](mailto:customcdi@aim.com) • [www.customcdi.com](http://www.customcdi.com) •

A FULL SERVICE RESIDENTIAL AND LIGHT COMMERCIAL DESIGN/BUILD FIRM



**Let us take the  
worry away.**



1st National Bank specializes in keeping your best interest in mind. As a community bank, we turn local deposits into affordable and flexible loans for you.

So, whether you're ready to live your dream of owning a boat, open the door to your new home, or open your first business, 1st National Bank can help. We listen to your needs and offer solutions that are right for your stage in life.

**Come in. Have a conversation.  
Let us take the worry away.**



1st National Bank  
855.876.1500

[www.FirstNationalBanks.biz](http://www.FirstNationalBanks.biz)

Member FDIC | Equal Housing Lender

Looking to sell your Lake Wisconsin Property?  
**LIST WITH THE LAKE PROPERTY EXPERTS**



**Terra Firma**  
TFM WISCONSIN, INC.

**(888) 470-5253**

[www.TFMwisconsin.com](http://www.TFMwisconsin.com)

[www.LakeWisconsinProperty.com](http://www.LakeWisconsinProperty.com)

- ✓ Proven History of Real Estate Success
- ✓ Lake Property Marketing & Sales Experts
- ✓ Huge database of Vacation Home Buyers
- ✓ Local Area and Home Market Expertise
- ✓ Looking to list? Use us for the best results!

Auto • Life • Business • Boat & Recreational Vehicles • Home/Renters



Now Offering:  
Auto Bind  
Online  
24/7 Storefront



Gary L. Witt, Witt Agency, LLC

Bus. Phone/Fax: **608.745.1547**

[www.farmersagent.com/gwitt](http://www.farmersagent.com/gwitt)

[gwitt@farmersagent.com](mailto:gwitt@farmersagent.com)

120 Henry Dr., Ste.3, Portage, WI 53901

## Accounting Solutions & More, LLC

**Joe Aliota, CPA**

3733 Grandier Road

Sun Prairie, WI 53590

**608-698-4338**

- Small Business Accounting
- QuickBooks Services
- QuickBooks Training
- Payroll
- General Bookkeeping
- Non-Profit Organizations
- New Business Formation

## Norski Technology Solutions LLC

- Malware removal
- Performance recovery
- Hardware upgrades
- Purchasing consultation
- File backups
- Digital signage
- Network setup
- Mobile support
- Tablet setup
- Computer builds
- Gaming computers
- IP camera setup
- Connectivity issues
- Expansion and addition
- Network security



[inquiry@norskits.com](mailto:inquiry@norskits.com)

(608) 620-4288

[www.norskits.com](http://www.norskits.com)

Services you can trust. Quality you can afford.

**BBH&C**  
reson  
**BAYBROOKES**  
HEATING & COOLING

■ 608.644.1719 ■ [www.BayBrookes.com](http://www.BayBrookes.com)

■ 507 Water St ■ Sauk City, WI 53583

Serving South Central Wisconsin

**BBH&C**  
24 hour emergency service

Whatever it takes.



Brett & Rhonda Herschleb

## Nations Title Agency Offers:

Closing & Title Professionals With Decades Of Experience

The Ability To Close Anywhere Locally & Nationwide

A High Level Of Service At Competitive Prices • Quality And Innovative Products



Nations  
Title  
Agency

**Marybeth A. Call**

608-284-0198 • [macall@nationstitle.com](mailto:macall@nationstitle.com)

5250 E. Terrace Dr, Ste F, Madison, WI 53718



# Kirk's Korner



## What Happens When the Phosphorus Levels Get *TOO HIGH* in the Lake?

**D**id you know...One pound of phosphorus can produce 500 pounds of algae? Phosphorus is the cause of the excessive algal growth in the river and its impoundments. Some of this happens naturally while some of it is caused by human activity. For this addition of Kirk's Korner, I'm adding a little homework for you... very simple though. After reading the short introduction below, please go to the following website [www.youtube.com/watch?v=GaensnYw\\_RI](http://www.youtube.com/watch?v=GaensnYw_RI) to view a flyover of the Wisconsin River Watershed.

While you enjoy watching this flyover on YouTube, please watch for phosphorus concentrations (in bright green) from the Wisconsin River, noted as "Main" (Main Stem) and "Trib" (tributaries to the river). The values are displayed as micrograms per liter (ug/L), otherwise known as parts per billion. Notice how the phosphorus concentration changes as you follow the river downstream and how one tributary varies from another.

The ultimate goal is to develop a tool to help decrease the amount of phosphorus going into the river.

Working together we can improve the water quality of this great natural resource so that our namesake's river, the Wisconsin River, can be enjoyed by all, now and into the future.

As a Lake Wisconsin resident, I ask you to think about our lake and the fact that what happens upstream also happens here - on Lake Wisconsin... Now let's take a trip down the river...

**Video Intro:** *The Wisconsin River has certainly earned its title of the hardest working river in the nation. Taking a bird's eye view of the watershed starting at its headwaters located near Lac Vieux Desert, follow the Wisconsin River as it meanders 430 miles across the state, making its way from the forested north, across the central glacial plain, and through the driftless area of the southwest, eventually draining into the Mississippi River at Prairie Du Chien. Along its journey, the Wisconsin River encounters a variety of landscapes, which collectively drain approximately 1/5 of the state, and have varying effects on water quality.*

As you travel downstream, note the increase in development with

respect to the municipal and industrial sectors, in addition to the growing amount of agricultural lands throughout the watershed.

Phosphorus concentrations in the river and its tributaries also show an increasing trend as you travel south, as discharges to the river compound and flows are slowed and disrupted. These elements combine to create problematic algal blooms in many of the river's reservoirs and low areas as phosphorus accumulates, only to start the whole process over as soon as the water rolls over the spillway...

The flyover video was created for the 2014 Wisconsin River Water Quality Improvement Symposium. It was a Collaboration by: Center for Watershed Science and Education; UW-Extension Lakes; Center for Land Use Education, and the College of Natural Resources at UW-Stevens Point

Please note the Lake Wisconsin Alliance (LWA), your local citizen's advocacy organization for Lake Wisconsin and its residents, supports all efforts to reduce phosphorus loads throughout the entire Lake Wisconsin watershed.

***Do you have a question about Lake Wisconsin or the Wisconsin River?  
If so, please send your question to [newsletter@TFMwisconsin.com](mailto:newsletter@TFMwisconsin.com).***

## Be Part of Your Newsletter...

To make your newsletter even better, we invite you to submit your information to be published in *Lake Wisconsin Living*. Do you want to highlight stories about your friends, family activities you have experienced, etc.?

Let us know by emailing your information to [newsletter@TFMwisconsin.com](mailto:newsletter@TFMwisconsin.com).

**We look forward to hearing from you!**

# Calendar of Events

**LODI Art in the PARK – July 4<sup>th</sup>, 10am-4pm.** Come enjoy the day at Haberman Park on Fair St in Lodi. More than 80 artists displaying jewelry, oil paintings, woodworking, and much more. Rain or shine.

**LODI AGRICULTURAL FAIR – July 9<sup>th</sup>-12<sup>th</sup>,** Lodi Agricultural Fairgrounds, 700 Fair St. A 4-day celebration with music, raffles, food, softball tournament, exhibits, carnival rides, entertainment, demolition derby, horse pull, tractor/truck pull and more. For additional information: [www.lodiagfair.com](http://www.lodiagfair.com)

**SAUK COUNTY FAIR – July 6<sup>th</sup>-12<sup>th</sup>.** Free admission. Sauk County Fairgrounds, 700 Washington Avenue, Baraboo. Visit [www.saukcountyfair.com](http://www.saukcountyfair.com) for complete schedule of events.

**LAKE MILLS Art FESTIVAL – July 18<sup>th</sup>, 10am-4pm,** Commons Park, 100 N. Main St., Juried art show, food music and activities for children.

**COLUMBIA COUNTY FAIR – July 22<sup>nd</sup>-26<sup>th</sup>,** games, carnival, food, moto cross, tractor pull, rodeo, demolition derby, and more. Visit [www.columbiacfair.com](http://www.columbiacfair.com) for a complete schedule.

**WaunaFest – July 23<sup>rd</sup>-26<sup>th</sup>,** Carnival with softball, volleyball and other tournaments, live music, craft fair Saturday, beer tents and food stands. Visit [www.waunafest.org](http://www.waunafest.org) for more info.

**ARLINGTON FIREMAN'S FESTIVAL at Fireman's Park – July 30<sup>th</sup>-Aug 2<sup>nd</sup>,** Softball Thursday, Truck/Tractor Pull Fri & Sat, music Fri & Sat, volleyball, softball and horseshoe tournaments, and more. Visit [www.arlingtonfiredept.com](http://www.arlingtonfiredept.com) for complete schedule.

**MERRIMAC COMMUNITY FESTIVAL – Aug 1<sup>st</sup>, 9am-8pm.** Merrimac Memorial Park at Front & River Streets, along the beautiful shoreline of Lake Wisconsin. Chicken barbeque, art & craft fair, horseshoe tournament, kids games, music, raffles, water ski show, food vendors, beverage tent and more. Visit [www.villageofmerrimac.org](http://www.villageofmerrimac.org) for complete schedule of events.

**HARMONY GROVE 44<sup>th</sup> Annual Brat & Beer Fest – Aug 6<sup>th</sup>-9<sup>th</sup>,** Lewis Byrnes Park, intersection of Cross Street and Rodney Drive. Softball tournaments, food, music, & raffles.

**Fitz's CORN BOIL – Aug 13<sup>th</sup>, 5-10pm.** W11602 County Road V, Lodi – Fitz's Annual Corn Boil fundraiser for Lodi Area Non-profits is a great outdoor event has it all - music, raffles, auction and fun for the whole family. Dinner includes brats and corn-on-the-cob. For additional information call 608-592-3302 or go to [www.fitzrestaurantlakewisconsin.com](http://www.fitzrestaurantlakewisconsin.com)

**SUSIE the DUCK DAY, Aug 15<sup>th</sup>.** Duck Race starts after the parade at Veterans Park and ends at Goeres Pak in downtown Lodi. Family-fun event with activities including Duck Derby race on Spring Creek with prizes, Search-for-Susie kids game, car show, dining, music and food. Downtown Lodi. Parade at 12noon on Main St. sponsored by Lodi Rotary. Admission is FREE. Visit [www.lodilakewisconsin.org](http://www.lodilakewisconsin.org) for details

**PANCAKES & PLANES FLY-IN Breakfast, Aug 16<sup>th</sup>, 7:30am-12noon,** Division St & Woodland Drive, Waunakee; sponsored by Waunakee Airport & Pilots Association. Adults \$6.00, Children under 12 \$4.00. Visit [www.waunakeechamber.com](http://www.waunakeechamber.com) for more information.

**WOLERSHEIM WINERY Distillery GRAND OPENING, Aug 14<sup>th</sup> & 15<sup>th</sup>, 10am-4pm,** Wollersheim Winery, 7876 Hwy 188, Sauk City... Open for self-guided tours, tasting of Coquard

Brandy and a few other distilled spirits. Music on Saturday. Visit [www.wollersheim.com](http://www.wollersheim.com) for additional information.

**CHALK WALK, Artisans Fair, Dance Party & Outdoor Movie, Aug 20<sup>th</sup>, 12noon,** Downtown Waunakee. Local art vendors will have work on display starting at noon; chalk walk in downtown Waunakee 5-6:30pm; dance party starts at 6:30pm, and outdoor movie begins at dusk. Visit [www.vil.waunakee.wi.us](http://www.vil.waunakee.wi.us) for additional information.

**SUMMERSET FESTIVAL of the ARTS, Aug 22<sup>nd</sup>, 10am-11pm,** Live music, food & drink, performances, workshops, visual arts, theatre, dance, film, literature, creative writing for all ages. Visit [www.baraboo.uwc.edu/campus/arts/summerset](http://www.baraboo.uwc.edu/campus/arts/summerset)

**BADGER STEAM & GAS Engine SHOW – Aug 21<sup>st</sup>-23<sup>rd</sup>, 8am-5pm,** Huge flea market with over 600 vendors, crafts, antiques, auction, music, food and more. Badger Steam & Engine Showgrounds, S3347 Sand Rd, Baraboo. Call 608-393-3021 or visit [www.badgersteamandgas.com](http://www.badgersteamandgas.com) for more info.

## LAKESIDE BAR & GRILL

W10960 Corning Street, Poynette, WI 608-635-2959 or [www.lakesidebarwi.com](http://www.lakesidebarwi.com)

- Happy Hour 75¢ off all drinks and snacks, 3-6pm
- Texas Hold-em tournaments Mondays at 7pm
- DJ every Saturday at 9pm or 10pm

## BANDS

- July 4<sup>th</sup> – Times TBD – High Voltage Mobile DJs outside
- July 5<sup>th</sup> – 1-5pm, 5<sup>th</sup> Gear Band
- July 11<sup>th</sup> – 2-6pm, Blues Party Band
- July 25<sup>th</sup> – 3-7pm, Retro Specz
- Aug 2<sup>nd</sup> – 2-6pm, Funky Chunky
- Aug 8<sup>th</sup> – 2-8pm, Saturday Morning Cartel
- Aug 29<sup>th</sup> – 2-6pm, Trailer Kings
- Sept 5<sup>th</sup> – 2-6pm, 5<sup>th</sup> Gear
- Sept 6<sup>th</sup> – 2-7pm, Midlife Crisis
- Sept 12<sup>th</sup> – Times TBD, Chameleon

## LUCKY'S BAR & GRILLE on the LAKE

W11579 Hwy V, Lodi, WI 608-592-LUCK (5825) or [www.luckysbarandgrille.com](http://www.luckysbarandgrille.com)

- Tiki Bar, Gas fire pits and lower level patio
- Friday Fish Fry; groups of 6 or more need reservations

## BANDS

- July 3<sup>rd</sup> – 7pm, Karen Wheelock
- July 4<sup>th</sup> – 1pm, Beach Party DJ; 6pm, Kings of Radio
- July 5<sup>th</sup> – 3pm, Pat McCurdy
- July 10<sup>th</sup> – 7pm, Kaia
- July 11<sup>th</sup> – 1pm, Beach Party DJ; 6pm, Shelley Faith
- July 17<sup>th</sup> – 7pm, John Masino Band
- July 18<sup>th</sup> – 1pm, Beach Party DJ; 6pm, Jason Ray Brown
- July 25<sup>th</sup> – 1pm, Beach Party DJ; 6pm, The Blues Party
- July 31<sup>st</sup> – 7pm, Kaia
- Aug 1<sup>st</sup> – 1pm, Beach Party DJ; 6pm, Brandon Beebe
- Aug 7<sup>th</sup> – 7pm, Karen Wheelock
- Aug 8<sup>th</sup> – 1pm, Beach Party DJ; 6pm Beth Kille w/ Michael Tully
- Aug 15<sup>th</sup> – 1pm, Beach Party DJ; 6pm, Country Wide ROCKS
- Aug 21<sup>st</sup> – 7pm, Madison Malone
- Aug 22<sup>nd</sup> – 1pm, Beach Party DJ; 6pm, Katie Scullin
- Aug 28<sup>th</sup> – 7pm, John Masino Band
- Aug 29<sup>th</sup> – 1pm, Beach Party DJ; 6pm, Drive By Night
- Aug 30<sup>th</sup> – 3pm, Pat McCurdy
- Sept 4<sup>th</sup> – 7pm, Karen Wheelock
- Sept 5<sup>th</sup> – 1pm, Beach Party DJ
- Sept 6<sup>th</sup> – 12noon, Beach Party DJ
- Sept 6<sup>th</sup> – 4pm, John Masino Band





**SURF WAKE SKI TUBE RELAX**



Introducing  
the all new

**BUILT FOR LAKE WISCONSIN X-23**

### X-23 SPECS

Boat Length	22'9"
Draft	28"
Seating	15 pers
Surf Wake	Longest in the industry



MasterCraft  
Premier  
Pontoon

**REDLINEWATERSPORTS.COM**



*Specialists in*  
**Rainwater Harvesting,  
Rain Exchange,  
Pondless Waterfalls  
& Fountain Scapes**

- Rain Barrels •
- Storm Water Runoff •
- Member of the IBEW •
- Containment & Control •
- Licensed Nursery Grower •
- State Erosion & Sediment Inspector •
- Sediment & Erosion / Control Solutions •
- Bio - Engineering for Shoreline & Hillsides •
- Shoreline Protection / Low Energy to High Energy •

**Dixon**  
Shoreline / Landscaping

N6780 Cty. Hwy U Portage, WI 53901 • [www.dixonshoreline.com](http://www.dixonshoreline.com)  
e-mail: [info@dixonshoreline.com](mailto:info@dixonshoreline.com) • 608-742-5657

*Experience the Best Service Imaginable.*

**Aaron Meyer**

**Mortgage Loan Officer**

NMLS# 594379

**Building or buying a home? Contact Aaron today.**

[ameyer@SettlersWI.com](mailto:ameyer@SettlersWI.com)

Cell: 608.444.5178 Phone: 608.842.5024

**Settlers bank**  
[www.SettlersWI.com](http://www.SettlersWI.com)

MEMBER FDIC



## LOCAL HIKING, BIKING, WALKING & RUNNING EVENTS

*It's Summer... Time for some outdoor fun!*

- FREEDOM RUN** – July 4th. Visit [www.deforestbank.com](http://www.deforestbank.com)
- GREAT BACON 5K FUN RUN** – July 4th. [www.bbbfest.com/baconrun](http://www.bbbfest.com/baconrun)
- DANCES with DIRT DEVIL'S LAKE** – July 11th.  
[www.danceswithdirt.com](http://www.danceswithdirt.com)
- PARDEEVILLE Triathlon** – July 11th. [www.racedayeventsllc.com](http://www.racedayeventsllc.com)
- Trek WORS Cup & Midwest Regional MOUNTAIN BIKE Championship** – July 24th-26th. [www.worscup.org](http://www.worscup.org)
- PEDAL & PARTY in Pardeeville** – July 25th. [www.pedalandparty.com](http://www.pedalandparty.com)
- BLUE MOON HIKE** - July 30th. [www.iceagetrail.org/volunteer/chapters/lodi-valley](http://www.iceagetrail.org/volunteer/chapters/lodi-valley)
- ISTHMUS PADDLE & PORTAGE** – July 18th.  
[www.paddleandportage.com](http://www.paddleandportage.com)
- 37th Annual WaunaFest RUN** – July 25th. [www.waunafestrun.org](http://www.waunafestrun.org)
- Da DELLS DIRTIEST DASH** – Aug 1st. [www.active.com](http://www.active.com)
- 24th ANNUAL LODI LIBRARY RUN / WALK** – Aug 9th.  
[www.lodipubliclibrary.org](http://www.lodipubliclibrary.org)
- SILVER LAKE TRIATHLON** – Aug 15th. [www.silverlaketriathlon.com](http://www.silverlaketriathlon.com)
- TOUR de FORT** – Aug 16th. <http://www.active.com/fort-atkinson-wi/cycling/races/tour-de-fort-2015>
- MADISON MINI MARATHON** – Aug 22nd.  
[www.madisonminmarathon.com](http://www.madisonminmarathon.com)
- CATCH FOR a CURE 5K FUN RUN / WALK** – Aug 26th.  
[www.eventbrite.com](http://www.eventbrite.com)
- FULL MOON HIKE** - Aug 30th. [www.iceagetrail.org/volunteer/chapters/lodi-valley](http://www.iceagetrail.org/volunteer/chapters/lodi-valley)



[www.WiLakeside.com](http://www.WiLakeside.com)

# LAKE SIDE

Pizzas now Served  
Sunday - Thurs  
4 pm - close

Bar & Grill

LAKE WISCONSIN

Daily Lunch Specials  
Fri Fish Fry • Sat Prime Rib

*Best Sunset on the Lake*

W10960 Corning St • Poynette • 608-635-2959

Looking to sell your Lake Wisconsin Property?  
**LIST WITH THE LAKE PROPERTY EXPERTS**



**TerraFirma**  
TFM WISCONSIN, INC.

**(888) 470-5253**

[www.TFMwisconsin.com](http://www.TFMwisconsin.com)

[www.LakeWisconsinProperty.com](http://www.LakeWisconsinProperty.com)

- ✓ Proven History of Real Estate Success
- ✓ Lake Property Marketing & Sales Experts
- ✓ Huge database of Vacation Home Buyers
- ✓ Local Area and Home Market Expertise
- ✓ Looking to list? Use us for the best results!

**Lake Wisconsin Living**

To advertise in this newsletter, please email [newsletter@TFMwisconsin.com](mailto:newsletter@TFMwisconsin.com).

c/o 5008 Linde Lane, Suite 400  
DeForest, WI 53532

**TIME VALUE MAIL ~ DO NOT DELAY**

**clearVISION**  
 WINDOW CLEANING | POWER WASHING  
**CALL TO LEARN MORE!**  
**608.850.3147**

We'll help you  
*"Spruce Up"*  
 for SUMMER!

**Ask About Additional  
 SUPER Specials!**

- Professional Chandelier Cleaning
- Commercial & Residential Roof Cleaning
- Gutter Cleaning, Whitening & Protection Systems

**YES! YOU'RE PROTECTED UP TO  
 \$1,000,000!**

"We guarantee you will be completely satisfied with both the workmanship you receive and your entire service experience with Clear Vision Cleaning. You have my word on that."

Kyle Ballweg, Owner  
 Clear Vision Cleaning, LLC  
**608.850.3147**

**JUST \$227!**

REGULARLY \$300

**SUMMER WINDOW SPECIAL!**

Up to 20 Windows Inside & Out!  
 (Excluding Storms)

FREE Basic Screen Cleaning  
 FREE Frame and Wipe-Down

**JUST \$249!**

REGULARLY \$400

**SUMMER  
 PRESSURE WASH SPECIAL!**

ANY SIZE HOME  
 (Vinyl Only)